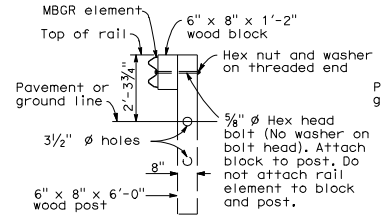

TABLE A
POST OFFSET DIMENSIONS

Post No.	3'-0" System End Offset	3'-6" System End Offset
1	36"	42"
2	22 1/4"	27 3/4"
3	11 3/4"	16 1/4"
4	6 3/4"	10 3/4"
5	3"	6"
6	3/4"	2 3/4"
7	0"	3/4"
8	0"	0"

See Note 12



SECTION A-A

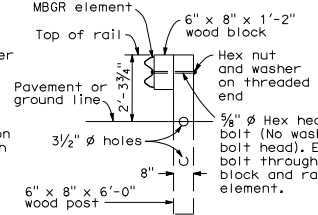

SECTION B-B

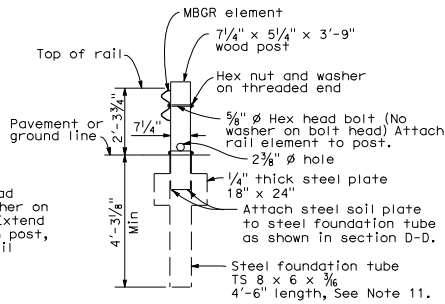

SECTION C-C

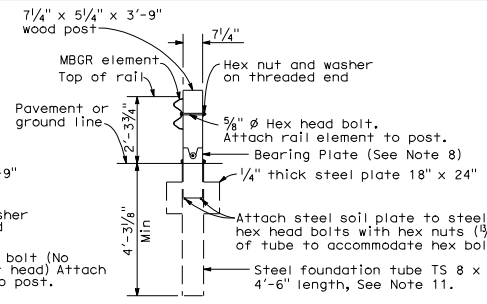

SECTION D-D
(Terminal Section not shown)

NOTES:

- For additional details of Terminal System (Type SRT), refer to the manufacturer's installation instructions.
- The post offset dimensions are given to the center of the traffic face of the block, except at the first two posts, where the dimension is to the center of the traffic face of the post. Offset points are to be located by chord measurements at the back of the rail equal to the nominal post spacings shown. Posts are to be set approximately radial to the railing at each post locations.
- Do not attach rail elements to posts 7 and 8.
- Attach strut to Post Nos. 1 and 2 foundation tubes with 5/8" diameter hex head bolts, washers and hex nuts. Bolts extend through the strut, steel foundation tube, and wood posts.
- For the length and type of metal beam guard railing or metal barrier railing the terminal system is attached to, see the Project Plans.
- Attach rail element to this post and block. Payment for this post, block and hardware is included in payment for the type of railing or barrier the terminal system is attached to, not part of payment for Terminal System (Type SRT).
- The deflector angle of the slot guard is to be positioned immediately downstream of the slots.
- For bearing plate orientation, refer to the manufacturer's installation instructions.
- For typical use of this terminal system with guard railing, see the A77E, A77F and A77G Series of Standard Plans. See Standard Plan A78E for typical use of this terminal system with single thrie beam barrier.
- A complete wrap around end section may continue to be used in existing installations. New installations shall be constructed with the 3/4" wrap end section shown.
- A 6'-0" length steel foundation tube, TS 8 x 6 x 3/8" without a soil plate, may be furnished and installed in place of the 4'-6" length steel foundation tube and soil plate shown. Minimum embedment of the 6'-0" length tube shall be 5'-9". A 3/8" diameter hex head bolt and nut shall be installed in the hole in 6'-0" length tube to keep the wood post from dropping into the tube.
- Where site conditions will not accommodate use of the standard 4'-0" system end offset, 3'-6" or 3'-0" system end offsets, as applicable, may be used. See Table A for post offset dimensions for 3'-6" and 3'-0" system end offsets.

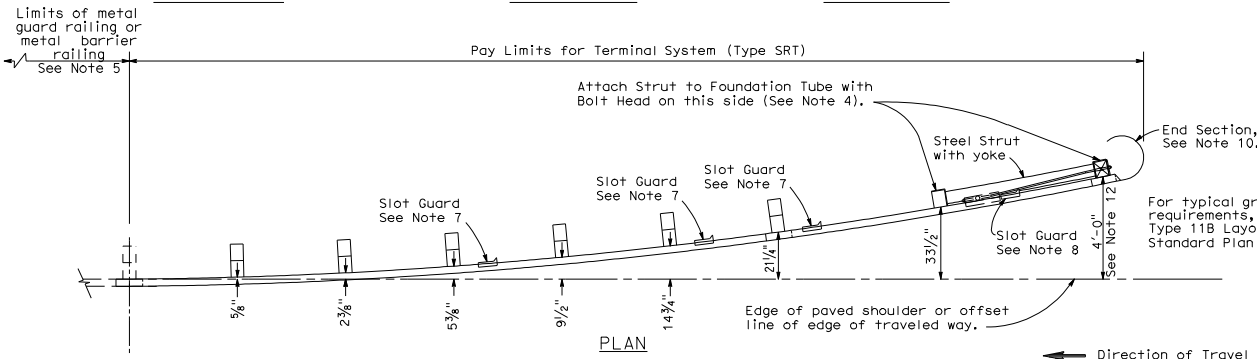

PLAN

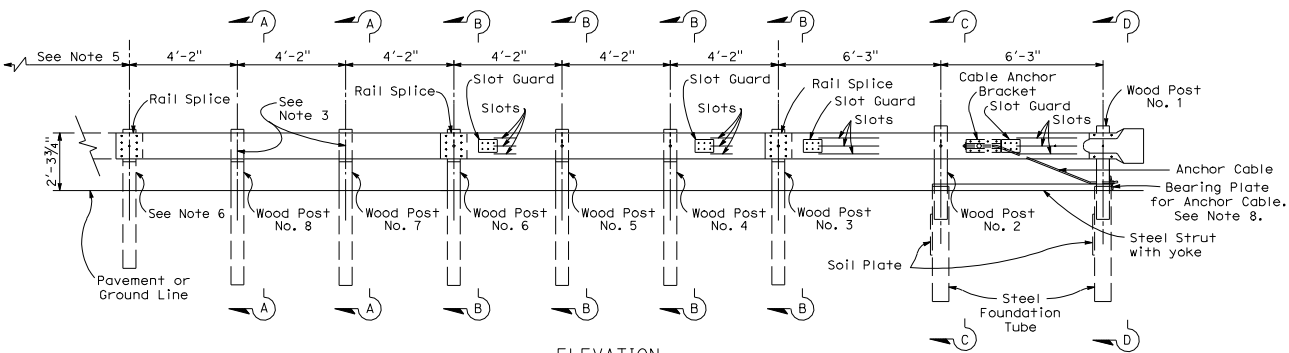

ELEVATION

TERMINAL SYSTEM (TYPE SRT)

(8 Post System)
See Note 9

DIST	COUNTY	ROUTE	POST MILES TOTAL PROJECT	SHEET NO.	TOTAL SHEETS

Randell D. Hiatt
REGISTERED CIVIL ENGINEER

May 1, 2006
PLANS APPROVAL DATE

The State of California or its officers or agents shall not be responsible for the accuracy or completeness of electronic copies of this plan sheet.

To get to the Caltrans web site, go to <http://www.dot.ca.gov>

REGISTERED PROFESSIONAL ENGINEER
No. C50200
Exp. 6-30-07
CIVIL
STATE OF CALIFORNIA

STATE OF CALIFORNIA
DEPARTMENT OF TRANSPORTATION
**METAL BEAM RAILING
TERMINAL SYSTEM
(TYPE SRT)**

NO SCALE

A77L1

2006 STANDARD PLAN A77L1